



# Tean Valley View

House Type

## Peveril

 Two bed bungalow



- Luxurious master bedroom with sophisticated en-suite and bespoke wardrobes combines style and comfort.
- Open-plan living area ideal for entertaining, equipped with top-quality finishes and AEG appliances.
- Eco-friendly home with underfloor heating and air source pumps, ensuring B-rated energy efficiency.
- Secure investment with a 10-year ICW warranty and modern safety features.
- Private, landscaped gardens with convenient external amenities for outdoor enjoyment.

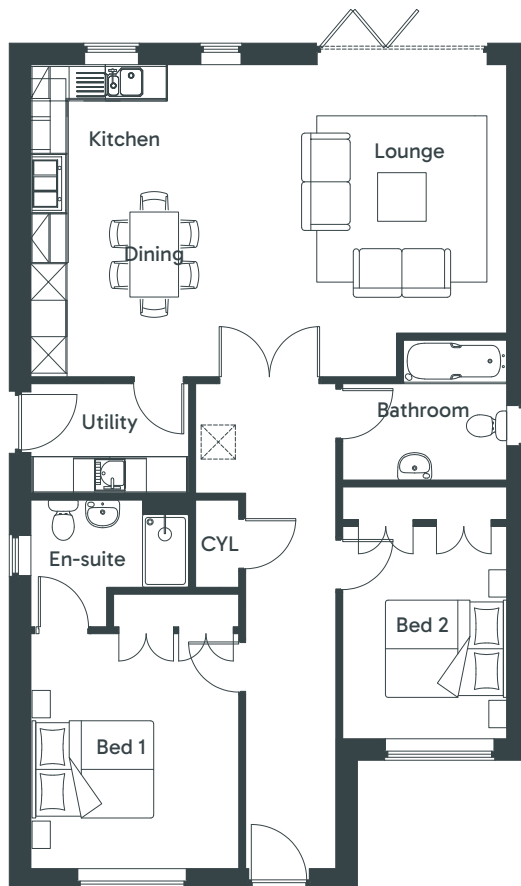

### Ground Floor

#### Kitchen/Dining/Lounge

7.83m x 5.13m / 25' 8" x 16' 10"

#### Utility

2.60m x 1.80m / 8' 7" x 5' 11"

#### Bed 1

3.41m x 3.86m\* / 11' 2" x 12' 8"

#### En-suite

2.61m x 2.08m / 8' 7" x 6' 10"

#### Bed 2

2.68m x 3.49m\* / 8' 10" x 11' 6"

#### Bathroom

2.69m x 2.30m / 8' 10" x 7' 7"

\* Plus Wardrobes

